

**CONSTRUCTION NOTES**

1. CURB STD. 24" CONC. & 18" GUTTER PER STD. DRAWING
2. CURB 3 1/2" P.C.C. SIDEWALK
3. CONST. STD. P.C.C. CONC. DRIVE W=36" PER STD. DRAWING
4. CONST. 2 1/2" P.C.C. CONC. DRIVE W=36"
5. REMOVE ALL OBSTRUCTING A.C. CONC., ETC.
6. CONST. CONC. DRIVE W=36" X=25"
7. INSTALL 2" WOOD WALKING SIGNS
8. CONSTRUCT 3' X 3' TREE WELLS

**ESTIMATE OF QUANTITIES**

CONC. CURB & GUTTER	WAL. LIN. FT.
CONC. DRIVEWAYS	1,384.50 SQ. FT.
CONC. SIDEWALK	1,098.53 SQ. FT.
A.C. ON ASD. BASE	1,400.50 SQ. FT.

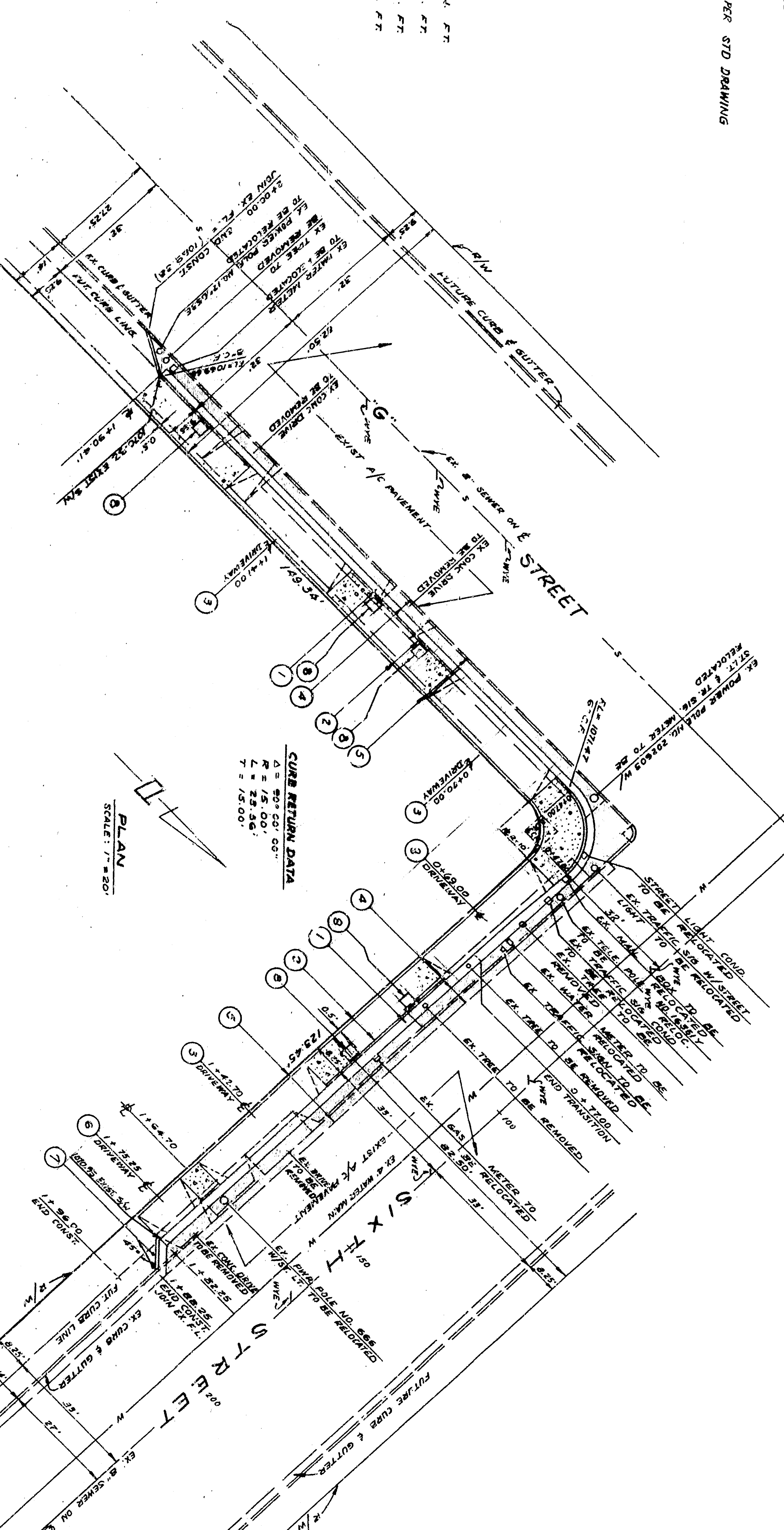
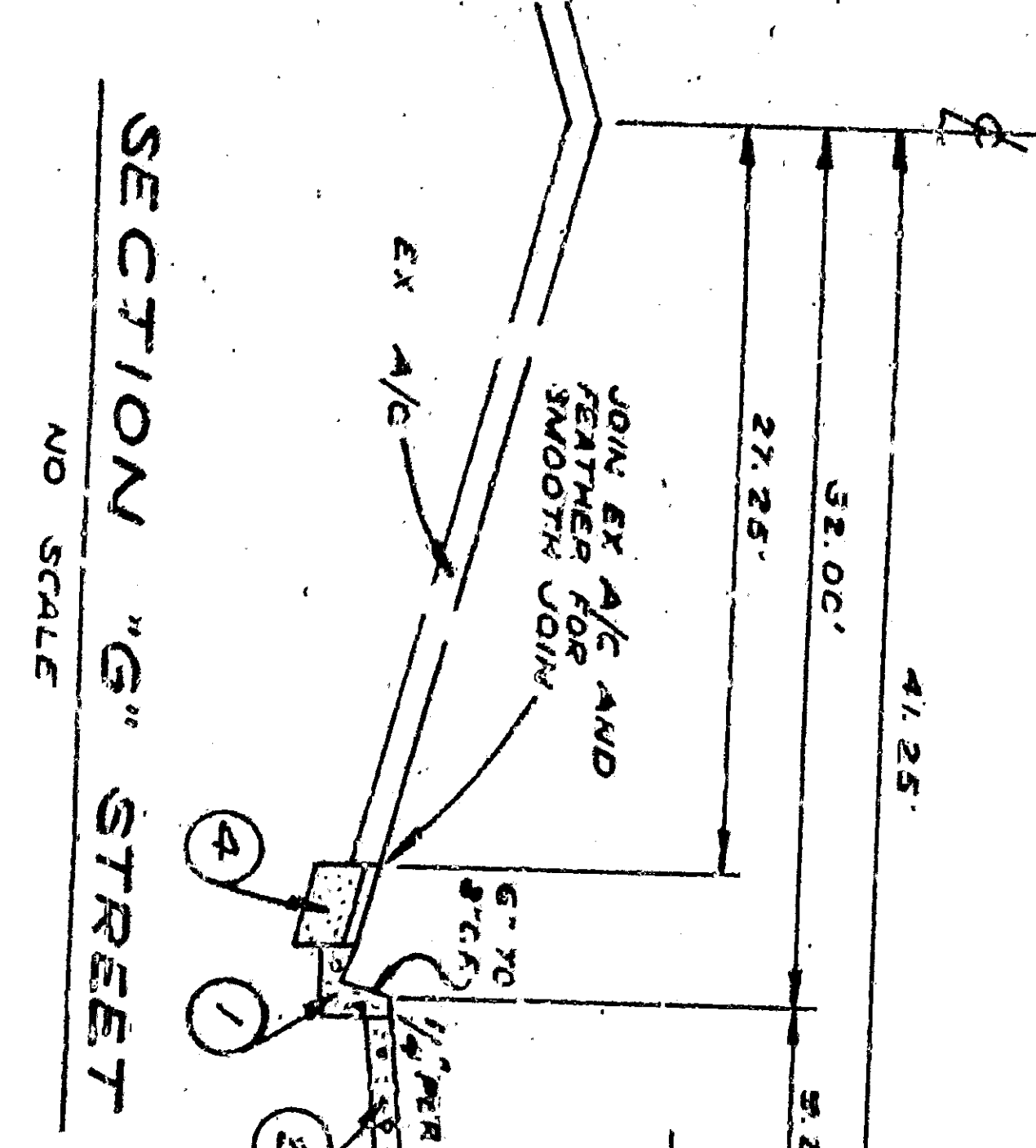

**GENERAL NOTES**

1. ALL WORK EMPLOYED ON THIS PLAN SHALL BE DONE IN ACCORDANCE WITH THE PROVISIONS OF STANDARD SPECIFICATIONS NO. 227 IN THE OFFICE OF THE CITY ENGINEER.

2. THE EXISTENCE AND LOCATION OF ANY UNDERGROUND UTILITY PIPE OR STRUCTURE OF THESE PLANS ARE OBTAINED BY A SEARCH OF THE AVAILABLE RECORDS OF THE CITY ENGINEER. THE ENGINEER MAKES NO WARRANTY AS TO THE ACCURACY OF THESE RECORDS. THE CONTRACTOR IS REQUIRED TO TAKE THE NECESSARY PRECAUTIONS TO PROTECT ALL UTILITIES SHOWN AND ANY OTHER LINES NOT SHOWN. THE CONTRACTOR SHALL BE RESPONSIBLE FOR ANY DAMAGE TO OR INJURY TO THEIR PROPERTIES DUE TO HIS OPERATIONS.

**DEPARTMENT OF ENGINEERING  
CITY OF SAN BERNARDINO**

PLAN AND PROFILE FOR STREET IMPROVEMENTS AT SIXTH STREET TO 196' EAST OF 'G' STREET AND TO 200' SOUTH OF SIXTH STREET

DESIGNED BY: J. A. BENTLEY  
CHECKED BY: J. A. BENTLEY  
DATE: 1/25/35

APPROVED BY: [Signature]  
REGISTERED CIVIL ENGINEER NO. 2522

DRAWING NO. 3342  
SHEET 1 OF 1 SHEET